

Notes:

Concrete blocks f_{uc}' 15 MPa

Mortar M3 (1:5 + methyl cellulose water thickener)

Concrete grout N20 (minimum cement 300 kg/m³, maximum aggregate 10mm)

Reinforcement shall be held in position by

- steel ligatures; or
- steel hangers; or
- plastic wheel type support

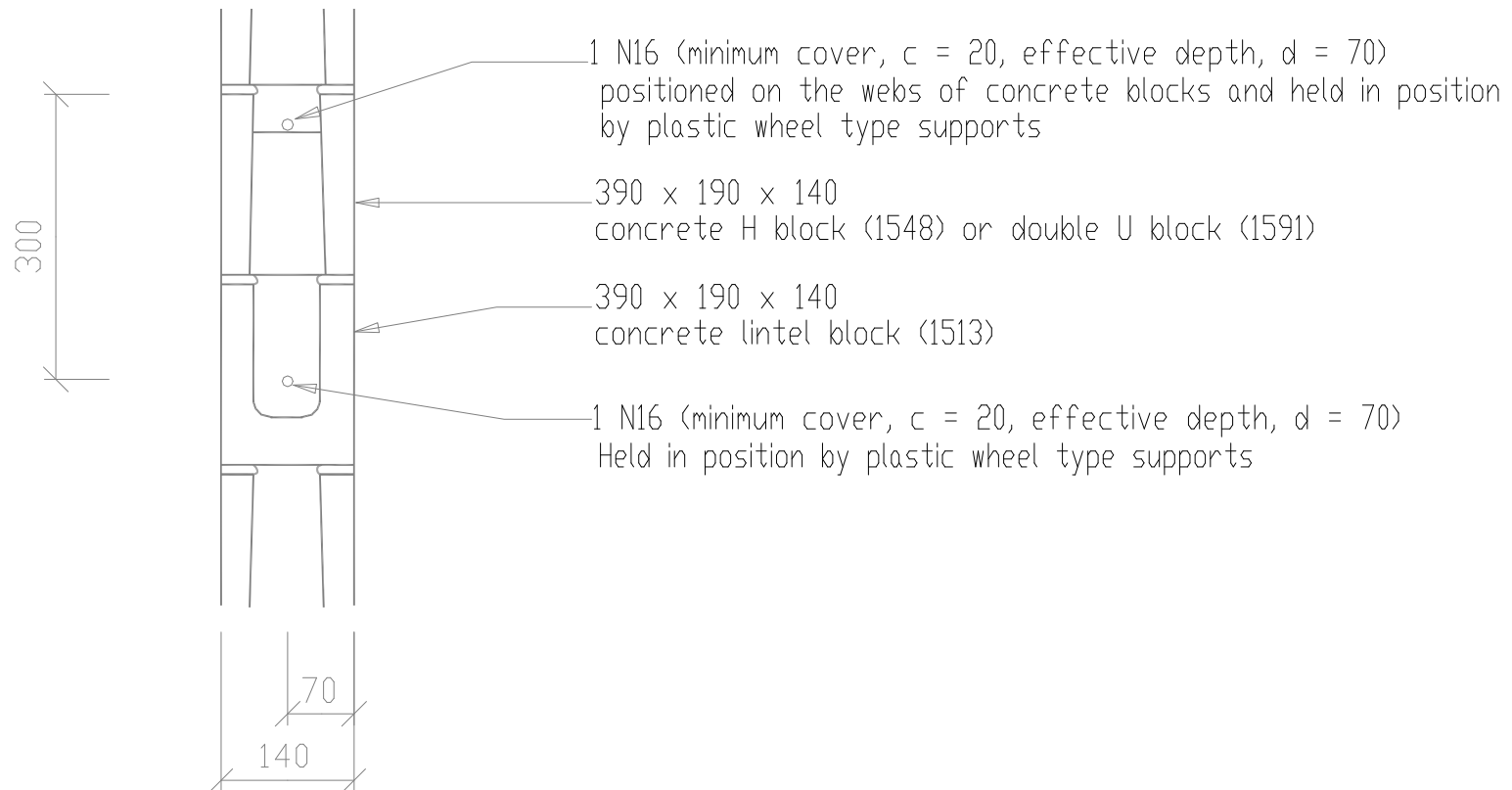

Reinforced Concrete Masonry Bond Beam Manufactured By Island Block & Paving

Scale 1:10