

# 240mm BLOCKS

**A full range of 240mm concrete building blocks are available from Island Block & Paving.**

Designers generally detail 240mm blocks for levelling up foundations, constructing the ground floor walls of two-storey dwellings as well as using them for lift shafts and retaining walls to achieve greater wall heights. The 240mm block width allows for 100mm of load bearing or stud width, a 50mm wide cavity to comply with the B.C.A. and additionally a 90mm block or 110mm brick.

## FAST FACTS:

- BCA Compliant
- 240mm width = compliant cavity for multiple story walls
- Greater Wall Heights can be achieved
- Made with Tech Dry water repellent additives
- Water repellent mortar additive available
- 12.5 blocks per m<sup>2</sup>
- 75 blocks per pallet

## TECHNICAL DATA:

Working Dimensions AS 4455.1 2008: + or - 2mm Dimensional Tolerance  
 Recommended Mortar per AS2758.1: 1 GP Cement + 1 Lime + 6 Clean Sand  
 Unconfined Compressive Strength: > 15 MPa  
 Material Density: 2150 Kg/m<sup>3</sup>  
 Average Dry Mass: 22900 g, 22.9 kg  
 Equivalent Wall Thickness: 143 mm  
 F.R.L. (Fire): Structural Adequacy / Insulation / Integrity - / 120 / 120  
 Sound Insulation Rating: Hollow 240mm Block 50 R<sub>w</sub>  
 Corefilled 240mm Block 55 R<sub>w</sub>

\* Deemed to comply with AS3700 per CMAA MA55 design manual

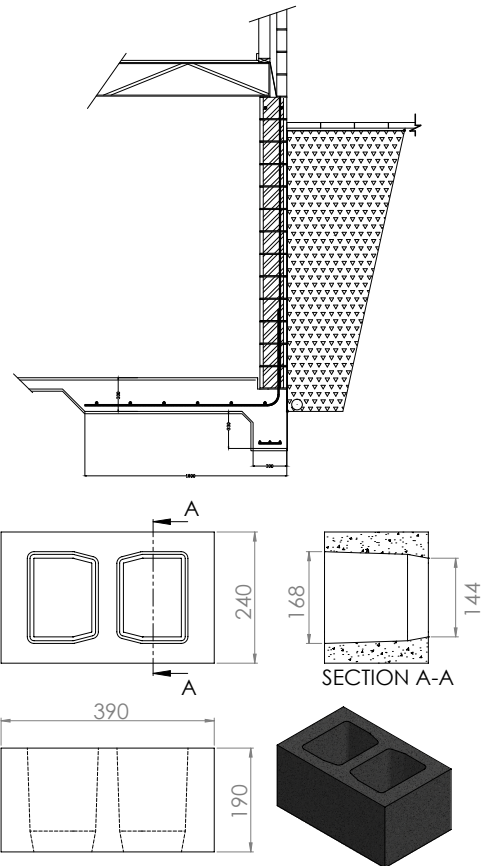

## CONTACTS

ISLAND BLOCK & PAVING  
 16525 Midland Highway,  
 Breadalbane,  
 Tasmania 7300

ISLAND BLOCK & PAVING  
 41 Howard Road,  
 Glenorchy,  
 Tasmania 7010

ISLAND BLOCK & PAVING  
 8 Metrolink Cct,  
 Campbellfield,  
 Victoria 3061

ISLAND BLOCK & PAVING  
 24/7 Display Only  
 16 River Road,  
 Wivenhoe, Tasmania 7320

TASMANIA

VICTORIA

SOUTH AUSTRALIA

NEW SOUTH WALES

QUEENSLAND

DISTRIBUTOR LIST: [islandblock.com.au/distributors](http://islandblock.com.au/distributors)

**FREECALL 1800 004 499**

Email: [sales@islandblock.com.au](mailto:sales@islandblock.com.au)  
[islandblock.com.au](http://islandblock.com.au)



*"No one knows Bricks, Blocks and Pavers better"*

